

KENWOOD

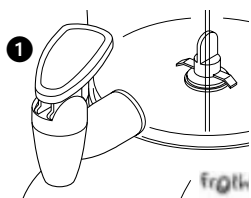

Frothie

CL420 series

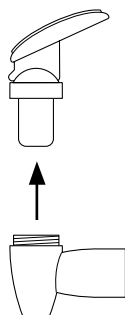
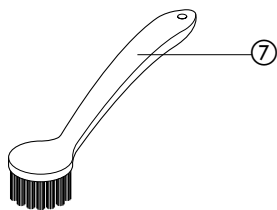
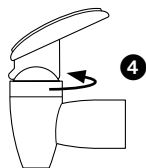
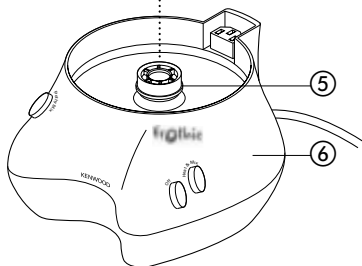
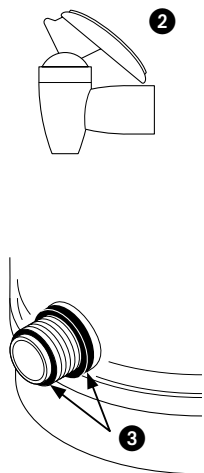
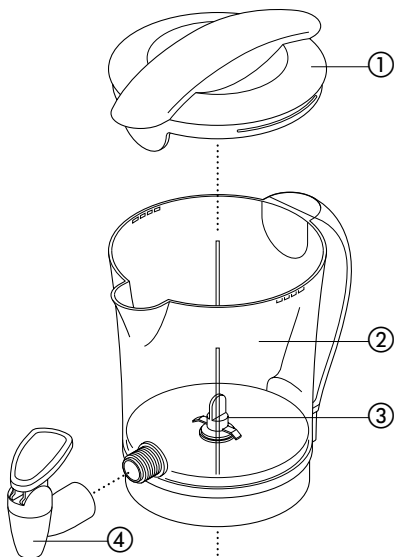

frgth

before using your Kenwood appliance

- Read these instructions carefully and retain for future reference.
- Remove all packaging and any labels.

safety

- Switch off and unplug:
 - before fitting and removing parts
 - after use
 - before cleaning.
- **Never immerse the goblet or allow the underside to get wet. Dry thoroughly before use.**
- Do not overfill as hot liquid may splash out during the blending operation.
- Never let the power unit, cord or plug get wet.
- Keep hands and utensils out of the goblet when it's on the power unit.
- Never use a damaged appliance. Get it checked or repaired : see 'service'.
- Never use an unauthorised attachment.
- Never leave the appliance on unattended.
- When removing the goblet from the power unit, wait until the paddle has completely stopped.
- Do not operate the appliance whilst the goblet is empty.
- Only operate the appliance with the lid in place.
- Only use the power unit supplied and keep it clean and dry.
- Beware, the appliance will get hot during operation.
- Keep small children away from the appliance and never let the cord hang down over the worktop edge - a small child could grab it and pull the appliance down.
- Take care when drinking liquids as they will be hot.

- Keep hot drinks out of childrens reach.
- Don't drink while holding your baby. If you're passing someone a drink, make sure a child isn't underneath.
- Do not let infirm people use the appliance without supervision.
- Do not let children use or play with the appliance.
- Only use the appliance for its intended domestic use. Kenwood will not accept any liability if the appliance is subject to improper use, or failure to comply with these instructions.

before plugging in

- Make sure your electricity supply is the same as the one shown on the underside of the machine.

Important – UK only

- The wires in the cord are coloured as follows:
Green and Yellow = Earth,
Blue = Neutral,
Brown = Live.
- The appliance must be protected by a 13A approved (BS1362) fuse.
- **WARNING: THIS APPLIANCE MUST BE EARTHED.**

Note:

- For non-rewireable plugs the fuse cover **MUST** be refitted when replacing the fuse. If the fuse cover is lost then the plug must not be used until a replacement can be obtained. The correct fuse cover is identified by colour and a replacement may be obtained from your Kenwood Authorised Repairer (see Service).
- If a non-rewireable plug is cut off it must be **DESTROYED IMMEDIATELY**. An electric shock hazard may arise if an unwanted non-rewireable plug is inadvertently inserted into a 13A socket outlet.
- The machine complies with European Economic Community Directive 89/336/EEC.

before using for the first time

- 1 Wash the parts: see 'cleaning'.
- 2 Wrap excess cord around the cord storage device on the underside of the appliance.

key

- ① lid
- ② goblet
- ③ paddle
- ④ tap assembly
- ⑤ drive
- ⑥ power unit
- ⑦ brush

to use your Frothie

- 1 Make sure the tap is correctly assembled to the goblet, then place on the power unit.
 - Check that the dispensing tap lever is in the off position ①.
- 2 Always place the liquid ingredients into the goblet first.
- 3 Then add the soluble ingredients eg. powdered hot chocolate, cocoa, malted drinks, coffee powder etc., or chopped chocolate.

Note:

This appliance is not designed to be a blender/liquidiser or to chop solid ingredients. Ingredients for flavouring purposes such as cloves and cinnamon sticks may be used but will need to be dispensed through a strainer before serving.

- 4 Fit the lid to the goblet so that the spout is covered.
- 5 Press the 'Heat & Mix' button, the mixing and heating operation will start straight away. The appliance will automatically stop when the correct temperature has been reached.
- 6 Place a cup under the tap, press the 'Frothy Mix' button and pull forward the dispensing tap lever.

- Using the 'Frothy Mix' button to dispense drinks will make the drink frothier and also help to dispense thicker drinks.
- 7 When the cup is almost full, release the lever to its off position and switch off by pressing the 'off' button.

hints

- For best results the drink should be consumed straight away.
- For extra richness, swirl some fresh cream on top of hot sweet drinks or add a dollop of freshly whipped cream.
- The maximum capacity of the Frothie is 1.2 litres and the minimum 200ml. A 1 litre mixture will be ready in approximately 9 minutes.
- If the goblet doesn't fit easily to the power unit, lift off and turn the drive on the power unit and re-fit.
- Your Frothie will also mix cold milkshakes. Pour the cold milk into the goblet then add the liquid or powder flavouring/concentrate and press the 'Frothy Mix' button. Allow to operate for 1 minute then place a cup under the tap, pull forward the dispensing tap lever. When the cup is almost full, release the lever to its off position and switch off by pressing the 'off' button.
- At anytime during the mixing and heating operation, you may switch off the Frothie by pressing the 'off' button.

important

- The base of the goblet is fitted during manufacture and no attempt should be made to remove it.
- Don't use the goblet as a storage container. Keep it empty before and after use.
- Some liquids increase in volume and froth during blending eg milk, so do not overfill and ensure the lid is correctly fitted.

cleaning

- Always switch off, unplug and dismantle before cleaning.
- Never allow the underside of the goblet to get wet.
- Never let the power unit, cord or plug get wet.
- Empty the goblet before unscrewing the tap.
- Always wash immediately after use. Don't let food dry onto the goblet assembly as this will make cleaning difficult. However, if food has accidentally been left to dry on, loosen it by filling the goblet with 1 litre of water and operate on the 'Heat & Mix' cycle.

- **Don't wash any part in the dishwasher.**

- Regularly dismantle the tap and clean the parts thoroughly.

goblet

Clean the inside of the goblet using the brush provided, then rinse thoroughly. Fill the goblet with warm water, open the tap and allow the water to flush through. Dry thoroughly and never let the underside of the goblet get wet.

power unit

- Wipe with a damp cloth, then dry.

lid

Wash by hand, rinse with clean water then dry.

cleaning the tap

Remove the tap assembly from the goblet, then soak the tap in hot soapy water with the valve open ②. Wash thoroughly then rinse and dry. Wash and dry the goblet then refit the tap ensuring that the seals are correctly positioned on the goblet ③.

dismantling the tap

- 1 Unscrew the dispensing tap lever ④.
- 2 Wash the components, then dry thoroughly.
- 3 Re-assemble the tap.

service and customer care

- If the cord is damaged it must, for safety reasons, be replaced by KENWOOD or an authorised KENWOOD repairer.

UK

If you need help with:

- using your Frothie
 - servicing or repairs (in or out of guarantee)
- ☎ call Kenwood Customer Care on **023 92392333**. **Have your model number ready** - it's located on the underside of the power unit.

- **spares and attachments**

☎ call 0870 2413653.

other countries

- Contact the shop where you bought your Frothie.

guarantee (UK only)

If your Frothie goes wrong within one year from the date you bought it, we will repair or replace it free of charge provided:

- you have not misused, neglected or damaged it;
- it has not been modified (unless by Kenwood);
- it is not second-hand;
- it has not been used commercially;
- you have not fitted a plug incorrectly; and
- **you supply your receipt to show when you bought it.**

This guarantee does not affect your statutory rights.

recipes

hot chocolate

1 litre/2 pints full fat milk
60ml/12tsp cocoa powder
50g/2oz caster sugar to taste
few drops vanilla essence

Place the milk into the goblet followed by the cocoa powder, sugar and vanilla essence. Press the 'Heat & Mix' button. Wait for the appliance to switch off and then dispense into a cup or mug.

Serves 4-5

coffee latte

800ml/28fl oz semi skimmed milk
150ml/6fl oz water
35ml/4 heaped tsp instant coffee granules
5ml/1tsp caster sugar or to taste

Place the milk, water, coffee granules and sugar into the goblet. Press the 'Heat & Mix' button. Wait for the appliance to switch off and then dispense into a cup or mug.

Serves 4

butterscotch warmer

1 litre/36fl oz full fat milk
large knob of butter
50g/2oz light soft brown sugar or to taste

Place the milk, butter and sugar into the goblet. Press the 'Heat & Mix' button. Wait for the appliance to switch off and then dispense into a cup or mug.

Serves 4-5